

DIRECTIONS TO WESTON TOWN HALL ANNEX

From the Merritt Parkway (Northbound): Take Exit 42. At the bottom of the ramp, turn right on Route 57 North. You will go under the Parkway. Go to the fifth (5th) traffic light (approximately 3.5 miles) and turn right on School Road. Bear left at the intersection. The Town Hall Annex is the second driveway on the left after the stop sign. Limited parking is available at the Annex and additional parking is available across the street from the Annex on the left.

From the Merritt Parkway (Southbound): Take Exit 42. At the bottom of the ramp, turn left on Route 57 North. Go to the fourth (4th) traffic light (approximately 3.5 miles) and turn right on School Road. Bear left at the intersection. The Town Hall Annex is the second driveway on the left after the stop sign. Limited parking is available at the Annex and additional parking is available across the street from the Annex on the left.

From Interstate 95 (Northbound): Take Exit 18. At the end of the ramp turn left on the Sherwood Island Connector. Continue straight until the road ends at Route 1. Make a left onto Route 1 (Post Road) and go to the first light and turn right onto Roseville Road. (There is a MacDonaldis on the corner). Continue until the road ends. Turn left onto Cross Highway. At the stop sign, turn right. At the next stop sign, go straight. There is another stop sign before the Merritt Parkway. Continue straight on Route 57 North. At the sixth (6th) traffic light, turn right on School Road. Bear left at the intersection. The Town Hall Annex is the second driveway on the left after the stop sign. Limited parking is available at the Annex and additional parking is available across the street from the Annex on the left.

From Interstate 95 (Southbound): Take Exit 18. At the end of the ramp turn right on the Sherwood Island Connector. Continue straight until the road ends at Route 1. Make a left onto Route 1 (Post Road) and go to the first light and turn right onto Roseville Road. (There is a MacDonaldis on the corner). Continue until the road ends. Turn left onto Cross Highway. At the stop sign, turn right. At the next stop sign, go straight. There is another stop sign before the Merritt Parkway. Continue straight on Route 57 North. At the sixth (6th) traffic light, turn right on School Road. Bear left at the intersection. The Town Hall Annex is the second driveway on the left after the stop sign. Limited parking is available at the Annex and additional parking is available across the street from the Annex on the left.

From Town Hall to the Annex: Turn right out of the Town Hall Parking Lot. At the light, turn right. At the next light turn right on School Road. Bear left at the intersection. The Town Hall Annex is the second driveway on the left after the stop sign. Limited parking is available at the Annex and additional parking is available across the street from the Annex on the left.

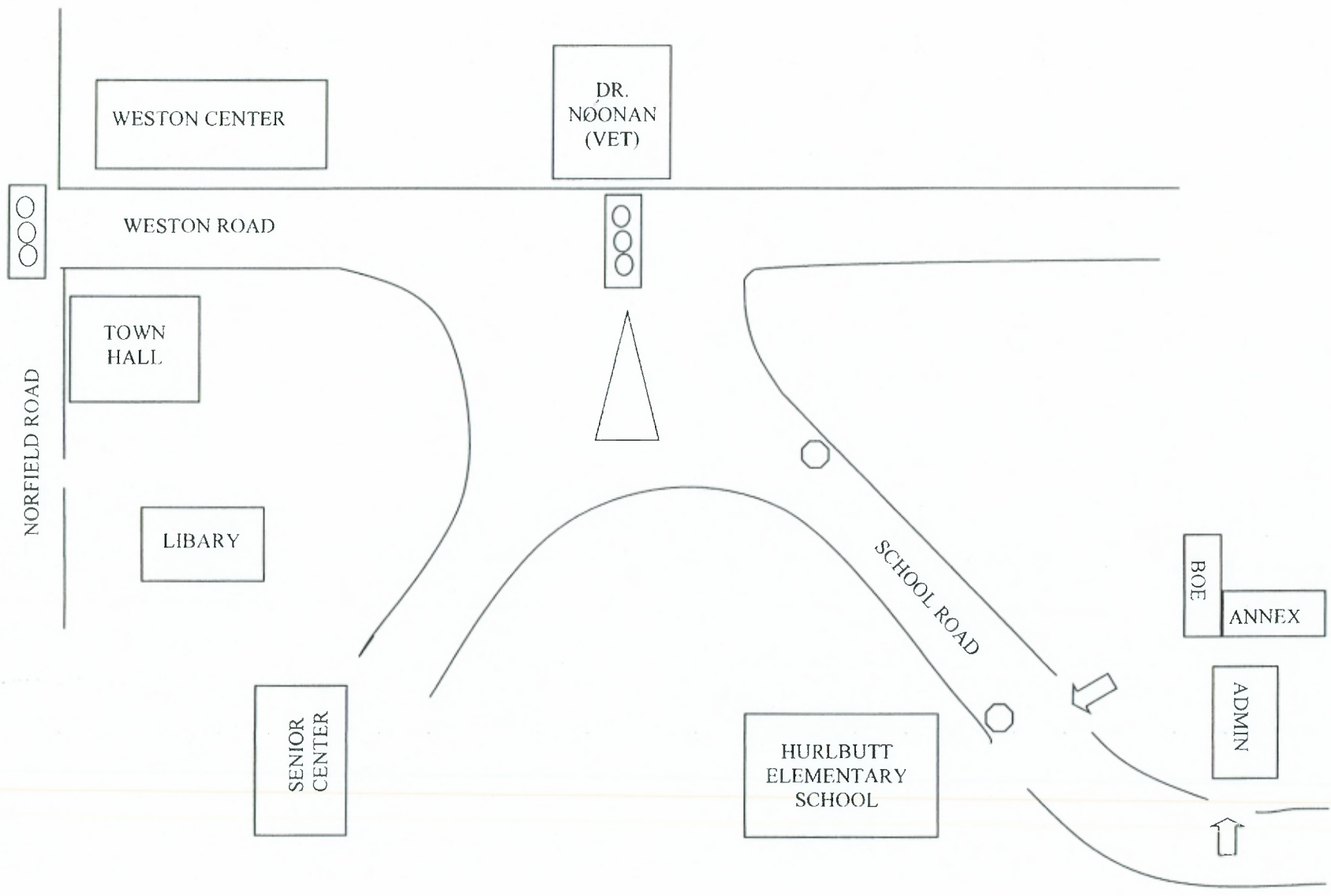

TOWN HALL ANNEX

24 SCHOOL ROAD

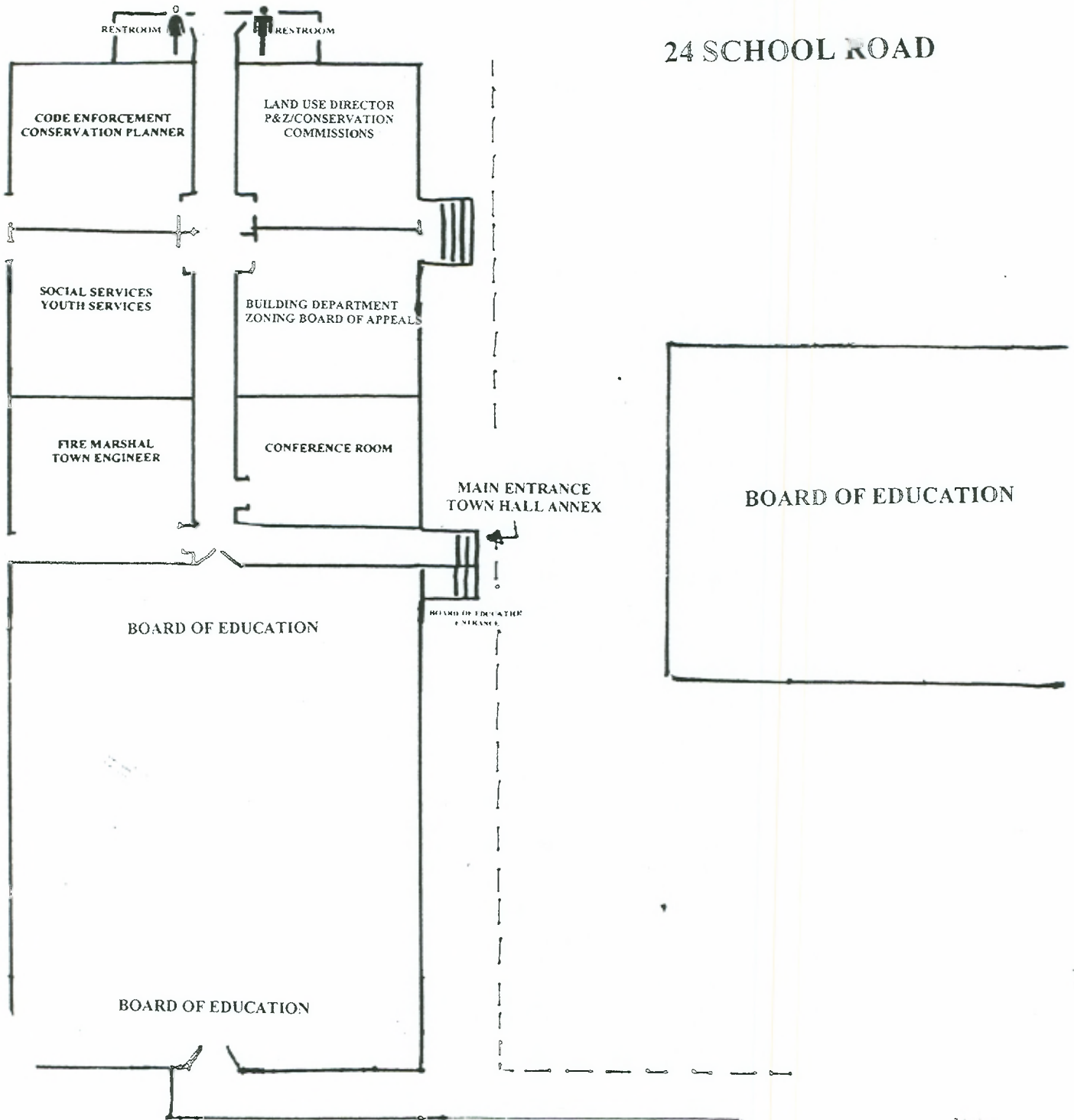

PARKING EXIT

PARKING ENTRANCE